

Concentric Rectangular to Round Transition

- ROUND RING TYPES**
- EZ** EZ CLAMPS
(AVAILABLE 4" - 14")
 - BC** BLACK IRON CAST RINGS
(AVAILABLE 4" - 12")
 - SC** STEEL CAST RINGS
(AVAILABLE 4" - 12")
 - BI** BLACK IRON ANGLE RINGS
(AVAILABLE 14" - 48")
 - SS** STAINLESS ANGLE RINGS
(AVAILABLE 14" - 120")

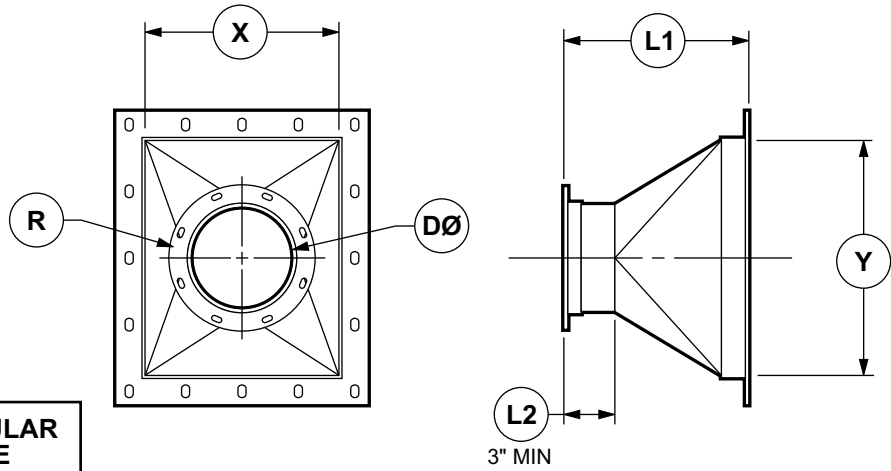

FOR ECCENTRIC RECTANGULAR TO ROUND FITTING, USE THE CUSTOM FITTING ORDER SHEET.

NOTES

- RAW END AVAILABLE.
- DUCT WIDTH OR HEIGHT OF 98" AND LARGER REQUIRES FAB-TECH ENGINEERING REVIEW.
- A CENTER STIFFENER (1" SCH40 PIPE) IS ADDED AT THE MIDPOINT OF THE FLANGE FOR DUCT WIDTH OR HEIGHT OF 50" AND GREATER.

FITTING NUMBER	QTY	- X - DUCT WIDTH	- Y - DUCT HEIGHT	- L1 - DUCT LENGTH	- DØ - ROUND DIAMETER	- R - RING TYPE	- L2 - THROAT LENGTH	REMARKS

REMARKS:

**COMPANY/
JOB REFERENCE**

