

**Eccentric Reducer**

**SPECIFICATIONS:**

- Schedule 10 stainless steel substrate for strength and light weight
- Proprietary fluoropolymer coating integrally bonded to interior surfaces for unparalleled corrosion resistance
- Gore-Tex<sup>®</sup> PTFE gasket for superior joint seals
- Straight pipe manufactured with floating flanges, all other fittings manufactured with fixed flanges, mounting holes straddle vertical centerline - floating flanges for fittings available on request
- Handles wide range of pressures from full vacuum to 150 psi
- Handles wide range of temperatures from -150°F (-66°C) to 300°F\* (149°C)
- Available in standard sizes 2" (50mm) thru 12" (300mm) diameter, straight lengths up to 10 feet
- Full compliment of reducers, tees, branches, elbows and custom manifolds for any system design up to 24" (600mm) diameter
- Fab-Tech can adapt to flanges in existing systems for easy connection

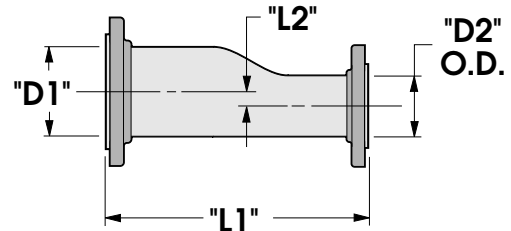
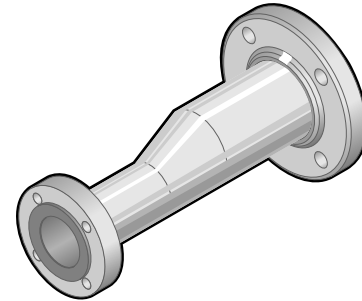

\* Chemical and temperature resistance data of the fluoropolymer coating used exclusively on PSP<sup>®</sup> products is detailed in the Chemical Compatibility guide available from Fab-Tech.

DESCRIPTION	"D1"	"L1"	"D2"	"L2"
3" TO 2" DIA ECCENTRIC REDUCER	3"	6"	2"	1/2"
4" TO 2" DIA CONCENTRIC REDUCER	4"	7"	2"	1"
4" TO 3" DIA CONCENTRIC REDUCER	4"	7"	3"	1/2"
6" TO 2" DIA CONCENTRIC REDUCER	6"	9"	2"	2"
6" TO 3" DIA CONCENTRIC REDUCER	6"	9"	3"	1-1/2"
6" TO 4" DIA CONCENTRIC REDUCER	6"	9"	4"	1"
8" TO 4" DIA CONCENTRIC REDUCER	8"	11"	4"	2"

- ALL DIMENSIONS IN INCHES
- CUSTOM PIPE LENGTHS LESS THAN 10' AVAILABLE ON REQUEST
- CHEMICAL AND TEMPERATURE RESISTANCE DATA OF THE FLUOROPOLYMER COATING USED EXCLUSIVELY ON PSP<sup>®</sup> PRODUCTS IS AVAILABLE FROM FAB-TECH.

Custom fittings available up to 24" diameter on request.