

**Sprinkler Adapter**

**NOTES**

- Refer to Fab-Tech's INSTALLATION AND ASSEMBLY GUIDE for assembly instructions.
- Fluoropolymer coating on flange face and o-ring surfaces.

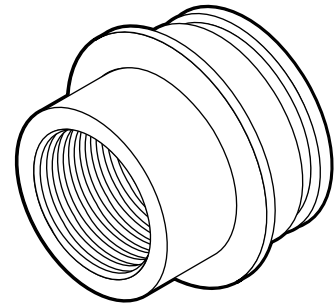

PART NO.*	DESCRIPTION	"D"	"L1"
<b>FTSP2</b>	2" SPRINKLER FLANGE	2"	1.10"
<b>FTSP3</b>	3" SPRINKLER FLANGE	3"	2.00"

\*PART NO. INCLUDES: ( 1 ) CLAMP, ( 1 ) GASKET & (1) VITON "O" RING

