

**16"-34" Heavy Duty Industrial Single Blade Damper**

**SPECIFICATIONS**

- Welded stainless steel rings
- Mounting holes straddle vertical centerline.
- Liquid tight shaft seals - thermoplastic sleeve bearings.
- 1.38" stainless steel axles - .25" stainless steel blades.
- Stainless steel quadrant plate.
- Multi-position handle, 5° lockout feature.
- Welded blade stops with Viton seal (3/16" x 1-1/2").

**OPTIONS**

- Pneumatic actuator.
- Electric actuator.
- Manual gear drive actuator.
- Custom actuator mounting kits.
- Custom hole pattern.

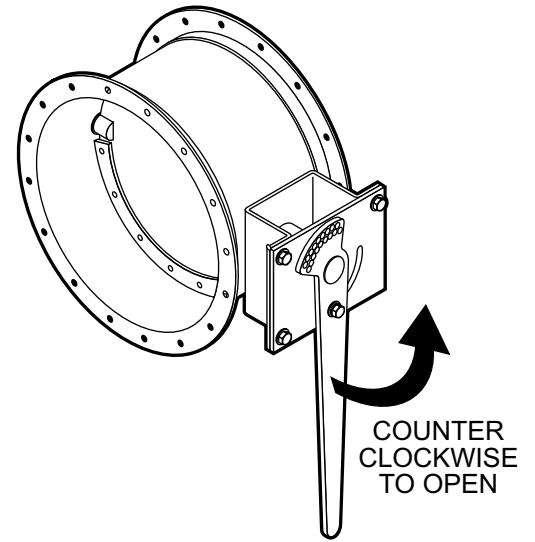

**WITH ANGLE RINGS**  
(AVAILABLE 16" - 34")

DIAMETER	BLADE	BODY
16" TO 34"	.25"	10GA

