

Straight Duct

DUCT DIA "D"	MIN GAUGE FOR 4' DUCT			MIN GAUGE FOR 8' DUCT		
	-6" WG	-12" WG	-18" WG	-6" WG	-12" WG	-18" WG
	4					
6						
8						
10						
12						20
14					20	
16		20				
18						
20				20		18
22						
24					18	
26	20					
28						
30						16
32			18			
34						
36						
38						
40					16	
42		18		18		14
44						
46						
48			16			
50						
52						
54						
56						
58					14	
60						
62	18			16		
64						
66						
68						
70		16	14			
72						12
74						
76						
78						
80						
82						
84						
86						
88						
90				14		
92						
94						
96					12	
98	16					
100						
102		14	12			
104						
106						
108						10
110						
112						
114						
116				12		
118						
120	14					

WITH JOINT SYSTEM

EZ CLAMP	4" - 14"
SS CAST RING	4" - 14"
BI ANGLE RING	4" - 94"
SS ANGLE RING	16" - 120"

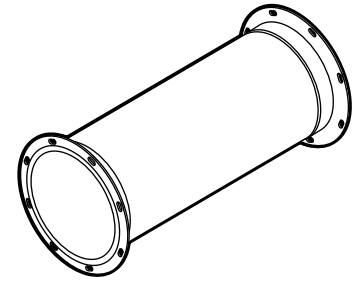

OR A COMBINATION OF JOINING SYSTEMS

OPTIONS:

- Custom lengths available.
- Duct greater than 84" diameter requires Engineering review and approval.
- Refer to FAB-TECH FLANGE SYSTEM section for adapters, drains and test ports.
- See Duct Gauge chart in STANDARDS section for other duct pressures.
- Raw end available.

NOTES:

- See INSTALLATION AND ASSEMBLY GUIDE for shortening 4" thru 22" duct in the field.

LONGER THAN STANDARD LENGTHS AND/OR HIGHER SYSTEM PRESSURES MAY REQUIRE ADDITIONAL STIFFENERS PER SMACNA, CONTACT FAB-TECH FOR SPECIFIC GUIDELINES.

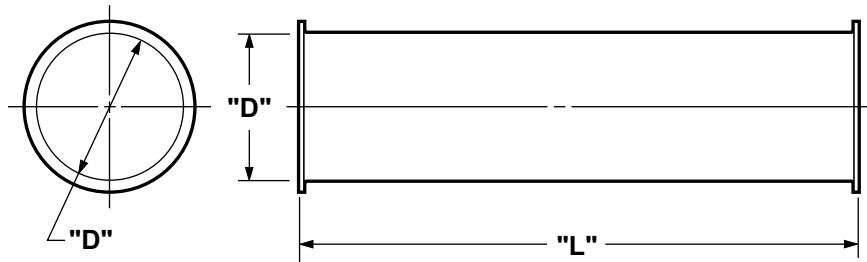

STANDARD DUCT LENGTHS ("L1")

JOINT SYSTEM	DIAMETER	"L1" (4')	"L1" (8')
EZ CLAMP / CAST RING	4" TO 14"	47.25"	
	8" TO 14"		95.25"
BLACK IRON ANGLE RING	4" TO 48"	47.25"	95.25"
	50" TO 94"	46.75"	94.75"
STAINLESS ANGLE RING	16" TO 48"	47.25"	95.25"
	50" TO 94"	46.75"	94.75"
	96" TO 120"	48.25"	96.25"